

SAFE-R 019

PHENOLIC
INSULATION

Pitched Roofs

SR019/MA (Roofs)

Avoids intrusion into
living area

Reduced risk of
condensation

Phenolic Insulation

Reduced Thermal Bridging



SAFE-R 019 PHENOLIC
INSULATION**Ventilated, Warm or Hybrid Sloped Roofs****SR019/MA (Roofs)**

Safe-R 019 Pitched Roof on sloped roofs (ventilated, hybrid or warm) provides the most efficient U-Values with minimal intrusion into valuable living space. The roof construction is a critical element in the building fabric and is an area at high risk of heat loss. Using SR019/MA (Roofs) will reduce heat loss while also delivering improved thermal bridging details.

Warm Roof construction is a particularly effective way of insulating complex roofs. Insulating above - or above and between - the roof timbers ensures that the structure is kept at or near the internal environmental conditions, reducing thermal stress and condensation risk.

Benefits

- Phenolic Insulation
- Avoids intrusion into living area
- Reduced risk of condensation
- Reduced Thermal Bridging

Specification Clause

The pitched roof insulation shall be Safe-R 019 SR019/MA (Roofs) ___mm manufactured to EN 13166 by Unilin Insulation, comprising of a rigid Phenolic core between composite foil facings. The SR019/MA (Roofs) ___mm with a declared Lambda value of 0.019W/mK to achieve a U-Value of ___W/m²K for the roof element. To be installed in accordance with instructions issued by Unilin Insulation.

Refer to NBS clause P10 140, P10 15, K11 695, K11 55, K10 245.
Uniclass Pr 25 71 63 59, Pr 80 77 76 62.

**Thermal Resistances**

Thickness (mm)	R-Value (m ² K/W)
75	3.90
80	4.20
100	5.25
150	7.85

Resistance 'R' Values

The resistance value of any thickness of material can be ascertained by simply dividing the thickness of the material (in metres) by its Agrément declared Lambda value, for example: Lambda 0.019 W/mK and thickness 100mm -> 0.100/ 0.019 -> R-Value = 5.25. In accordance with EN 13166, R-values should be rounded down to the nearest 0.05 (m²K/W).

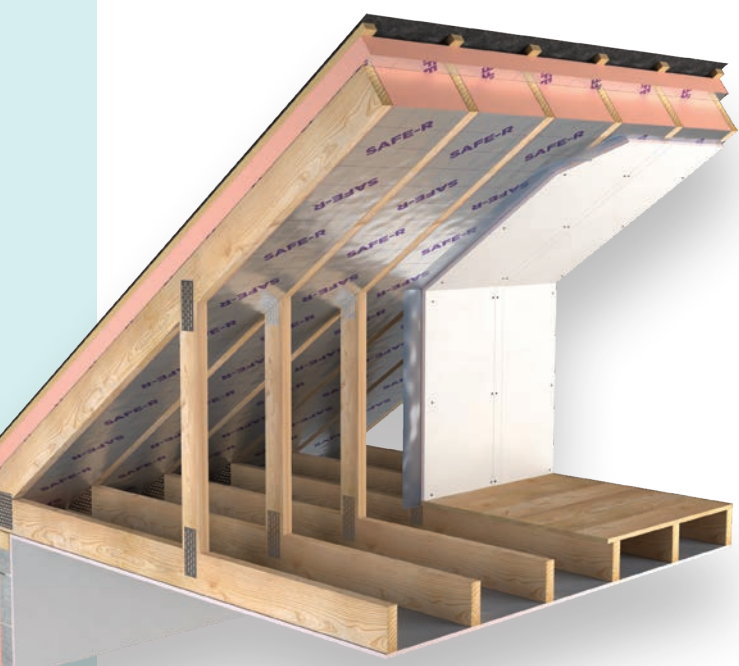

SR019/MA (Roofs)

1. In a conventional ventilated roof a 50mm clear ventilation gap should be maintained between the insulation and the roofing felt. In certain instances where a vapour permeable membrane is used the ventilation gap may be reduced or dispensed with, check with membrane manufacturer. Refer to manufacturer's guidelines.



2. In a ceiling, typically fibre glass is placed between and over the joists – this hides the top of the joist and may lead to health and safety concerns when the roof space is being accessed. The thermal bridge which occurs through the joists can be addressed by placing a layer of SR019/MA (Roofs) to the underside, before the plasterboard is fixed. Safe-R SR/TB Drylining boards can also be used. This allows for the roof space to be accessed in a safe manner leaving the top of the joists exposed, which allows the roof space to be used for storage.

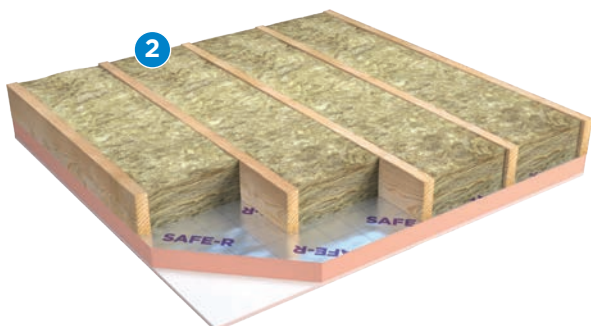

Note

Alternatively, a layer of insulation - covered with chipboard or OSB - can also be placed over the joists. XT/Walk-R offers a ready made solution for this application.

SR019/MA (Roofs)

Length (mm)	2400
Width (mm)	1200
Thickness (mm)	75, 80, 100

Other thicknesses may be available depending on minimum order quantity and lead time.

Property & Units

Thermal Conductivity	0.019 W/mK
Compressive Strength	100 kPa
Reaction to Fire	Euroclass C s2, d0

Unilin Declaration of Performance (DoP) for this product is available for download from our website.

NOTE

In every roof space where there are cold water tanks or services, for H&S reasons the Contractor should construct a permanent boarded walkway to access services. This walkway should be supported above the first layer of insulation to prevent any compaction of insulation below the walkway.

INSTALLATION GUIDELINES

SR019/MA (Roofs)

Ventilated Roof

1. Fix positioning battens to inner face of rafters, flush with the top edge of the timber.
2. Allow space for ventilation gaps, normally 50mm. (May be reduced depending on breather membrane certification).
3. Cut boards with fine toothed saw to fit tightly between rafters, flush with the bottom of the rafter. Allow slight oversize of cut to achieve 'friction fit' and seal any gaps with expanding foam.
4. If an additional second layer is required, this should be fixed to the underside of the rafter. Run second layer transverse to the first with joints tightly butted. Fix with nails to hold insulation in place until plasterboard is installed.
5. Provide a separate vapour control layer between insulation and plasterboard or alternatively, tape the joints of the insulation with an aluminium foil tape.
6. Finish with plasterboard fixed with drylining screws. Screw fix every 150mm, 12mm from edge of boards ensuring a minimum 25mm penetration into the rafter or alternatively follow plasterboard manufacturer installations guidance.

Alternatively the second layer can be achieved with SR/TB MF Drylining board.

Repeat steps 1 to 3 and replace second layer with SR/TB MF, a ready made Phenolic insulation board bonded to plasterboard. Where joints between sheets of SR/TB MF are unsupported by the rafters, timber noggins should be installed. Seal and tape the joints of the plasterboard in accordance with Standard Drylining Practice.

Hybrid Roof

Follow the same procedure as a ventilated roof except an approved Vapour Permeable underlay is used above the rafter allowing the 50mm ventilation space to be dispensed with. Typically, a 25mm unventilated void should be maintained; Agrément certification covering the membrane should be consulted.

Warm Roof

1. Ensure cavity wall insulation has continued to roof height to meet with the roof insulation.
2. Fix a treated timber stop rail to the end of the rafter at the eaves.
3. Lay SR019/MA (Roofs) staggered jointed over the rafters. Ensure joints are tightly butted and fill any gaps with expanding foam. Joints should be fully supported by rafters. Boards can be temporarily fixed with nails.
4. Fix 38mm x 50mm counter battens with approved fixings through the SR019/MA (Roofs) into the rafter. The amount of fixings is determined by the fixing manufacturer who can also provide wind load calculations.
5. A breathable sarking membrane should be fitted; refer to manufacturer's Agrément certification. Ventilation may have to be provided subject to that certification and minimises the risk of interstitial condensation forming on the underside of the membrane. Providing an unventilated void under the membrane can improve the thermal performance.
6. Secure 50mm x 25mm tiling battens through counterbatten and SR019/MA (Roofs) to the rafter.
7. If an additional second layer is required, this should be fixed between the rafters.
8. Cut boards with fine toothed saw to fit tightly between rafters, flush with the top of the rafter. Allow slight oversize of cut to achieve 'friction fit' and seal any gaps with expanding foam.
9. Provide a separate vapour control layer between the bottom of rafter and plasterboard.
10. Finish with plasterboard fixed with drylining screws. Screw fix every 150mm, 12mm from edge of boards ensuring a minimum 25mm penetration into the rafter or alternatively follow plasterboard manufacturer installations guidance.

THERMAL PERFORMANCE

SR019/MA (Roofs)

Typical U-Values

Table 1

U-Value calculations to EN ISO:6946:2017 SR019/MA (Roofs) Insulation for Pitched Roofs

Hybrid Roof

- Tiles
- Battens
- Breathable membrane
- Air layer between rafters
- SR019/MA (Roofs) between rafters
- SR019/MA (Roofs) below rafters
- Vapour control layer
- Plasterboard
- Plaster skim

Safe-R Thickness (mm)

Rafter Centres (mm)

Between	Under	600mm	400mm
100	50*	0.14	0.15
120	50*	0.13	0.14
100	75	0.12	0.12
120	75	0.11	0.11

*0.021 thermal conductivity

Table 2

U-Value calculations to EN ISO:6946:2017 SR019/MA (Roofs) Insulation for Pitched Roofs

Warm Roof

- Tiles
- Battens
- Breathable membrane
- SR019/MA (Roofs) over rafters
- SR019/MA (Roofs) between rafters
- Air layer between rafters
- Vapour control layer
- Plasterboard
- Plaster skim

Safe-R Thickness (mm)

Rafter Centres (mm)

Over	Between	600mm	400mm
75	75	0.13	0.13
80	80	0.12	0.13
100	75	0.11	0.11
120	75	0.1	0.1
120	-	0.15	0.15

HANDLING, CUTTING & STORAGE

Unilin insulation should be stored off the ground, on a clean, flat surface and must be stored under cover. The polythene wrapping is not considered adequate protection for outside exposure. Care should be taken to protect the insulation in storage and during the build process.

The insulation boards can be readily cut using a sharp knife or fine toothed saw. Ensure tight fitting of the insulation boards to achieve continuity of insulation as asked for within the ACDs. Appropriate PPE should be worn when handling insulation. Please refer to Health & Safety data sheets on our website.

The boards are wrapped in polythene packs and each pack is labelled with details of grade/type, size and number of pieces per pack.

Durability

Unilin Insulation products are stable, rot proof, provide no food value to vermin and will remain effective for the lifetime of the building, depending on specification and installation. Care should be taken to avoid contact with acids, petrol, alkalis and mineral oil. When contact is made, clean materials in a safe manner before installation.





Expect more Knowledge

Unilin Insulation is one of the UK's largest manufacturers and suppliers of insulation. We have a 20-plus year history of working in partnership with construction professionals to close the gap between design and as-built performance.

Higher standards of fabric performance call for greater adherence to best practice detailing. To achieve this and to 'close the gap' between design and build, we provide a dedicated Technical Team, all qualified to the highest standards of competency in U-Value calculation and condensation risk analysis.

Here to support you

- BRE listed Thermal Bridging Detailing
- BRE Trained Modelling
- Warranted Calculations available
- Immediate technical response
- SAP Qualified
- Insulation systems to deliver real onsite performance

Get in touch

T: +44 (0) 371 222 1055 E: tech.ui@unilin.com unilininsulation.co.uk

FREE
One-to-one
advice



Unilin Insulation UK Ltd
Park Road, Holmewood
Chesterfield, Derbyshire
United Kingdom
S42 5UY

t. +44 (0) 371 222 1033
e. info.ui@unilin.com

unilininsulation.co.uk



ISO 45001:2023+A1:2024	Occupational Health & Safety Management Systems
ISO 9001:2015+A1:2024	Quality Management Systems
ISO 14001:2015+A1:2024	Environmental Management Systems

The Sustainable Solution

Specifying Unilin Insulation is a real commitment to minimising energy consumption, harmful CO₂ emissions and their impact on the environment. Using our products is one of the most effective ways to reduce energy consumption – in fact, after just eight months the energy they save far outweighs the energy used in their production. In addition, our manufacturing facilities operate to an ISO 14001:2015+A1:2024 certified Environmental Management System.

Environmental Product Declaration (EPD)

An Environmental Product Declaration or EPD for a construction product indicates a transparent and credible step in the pursuit and achievement of real sustainability in practice, it is a public declaration of the environmental impacts associated with specified life cycle stages of that product. Unilin EPDs have been independently verified in accordance with EN 15804+A2:2019 and ISO 14025:2010 accounting for stages of the LCA from A1 to A3, with options A4-A5 and modules C1-C4 and D included. The process of creating an EPD allows us to improve performance and reduce resource wastage through improvements in product design and manufacturing efficiency. They play a crucial role in manufacturing and construction and are increasingly asked for by industry.

EPDs and BREEAM

BREEAM is primarily trying to encourage designers to take EPDs into consideration when specifying products. BREEAM requires EPDs to be verified by a third-party. For the Mat 02 category, points are awarded based on whether EPDs are generic, manufacturer-specific, or product-specific. Non 3rd party verified EPDs to EN 15804:2012+A2:2019 cannot be accepted. All of Unilin EPDs are externally verified.

Responsible Sourcing

Unilin has BES 6001 certification for responsible sourcing. The second BREEAM credit under that category is based on responsibly-sourced materials – at least 80% of the total insulation used in roofs, walls, ground floors and services must meet any of tier levels 1 to 6 in the BREEAM table of certification schemes. Our Environmental Management System is certified under EN ISO 14001:2015+A1:2024, and our raw materials come from companies with similarly certified EMS (copies of all certificates are available for BREEAM assessments). This level of responsible sourcing meets tier level 6 in the BREEAM table.

Good workmanship and appropriate site procedures are necessary to achieve expected thermal and airtightness performance. Installation should be undertaken by professional tradespersons. The example calculations are indicative only, for specific U-Value calculations contact Unilin Insulation Technical Support. Unilin technical literature, Agrément certifications and Declarations of Performance are available for download on the Unilin Insulation website. The information contained in this publication is, to the best of our knowledge, true and accurate at the time of publication but any recommendations or suggestions which may be made are without guarantee since the conditions of use are beyond our control. Updated resources may be available on our websites. All images and content within this publication remain the property of Unilin Insulation.